



HANGAR HRD65 Roller Shutter

Durability - Reliability - Quality



Hangar HRD65 Roller Shutters act as an excellent deterrent to intruders and vandals, while maintaining external attractiveness.

Widely used in retail applications, the HRD65 may also be applied to commercial and industrial applications, leisure centres, bar and deli counters and many other public and private buildings.

Superior Design

At Hangar, we use high quality materials to ensure you get superior products, reinforced with stringent manufacturing processes and quality control systems.

Complete Integration

The HRD65 can be integrated (cavity-fit) into the design of your building, eliminating the need for an extruding canopy. They can also be retro-fitted (face-fix) onto existing buildings to protect windows and entrances from vandalism and intrusion.

Transcreen - Enhanced Visibility

The Transcreen Shutter provides the traditional strength and durability of our Roller Shutter, but has the enhanced feature of perforated laths. Transcreen provides increased visibility for your business during closing hours. It is particularly beneficial during darkness hours when backlighting in your premises provides an almost transparent view of your display.

Easy Operation

Choose between electric or manual operation. For multiple electrically operated shutters, we also offer group control, ensuring the synchronised operation of your Roller Shutters with one push of a button.

Ultimate Finish

All elements of the Hangar HRD65 can be powder coated to ensure harmony with corporate identity and architectural elements.



Specification

Curtain

Deep Profile 65 or 75mm Galvanised or PVC coated steel curved lath.

The laths interlock along their entire length to form a continuous curtain. Lateral movement is reduced by End Locks fixed to each end of alternate laths. Each curtain fitted with Aluminium Base Section & Seal.

PVC coated Steel Lath: Colourcoat HP 200 to BS EN 10147 - Standard Colours Available

Galvanised Steel Lath to BS EN 2989.

Polyester Powder Coating Option - wide range of colours available.

Guides

50 or 75 mm deep for normal conditions. In cases where extreme conditions are encountered, extra deep guides can be provided.

Guides are bolted to steel or anchored to concrete, depending on the building structure.

Guides are Powder Coated to complement your curtain.

Plates

Manufactured from 3mm Zintec Steel and fitted with steel brackets to suit axle ends.

Canopy

Constructed from 1mm Galvanised Steel to BS 2989. It is secured to end plates and at the head in the majority of cases.

Axle

Type A : *Self-Coiling*

178mm High Tensile Torsion spring assembly to suit opening width, height and weight of curtain.

Type B : *Electric Operation*

89mm De-Prat or 102mm Steel Tube to BS4360-43C is fitted with a slip shaft in the offside end and a Tubular Motor in the drive end.

Full details on Motors are available upon request.

Operation

Electrical Operation achieved using Tubular Motor to suit Single Phase 220V power supply.

Choice of Rocker Switch or Key Switch operation.

Options include Remote Control Operation and Group Command Controls for operating multiple shutters simultaneously.

Our spring-assisted manually operated shutters offer unique smoothness and effortless operation.



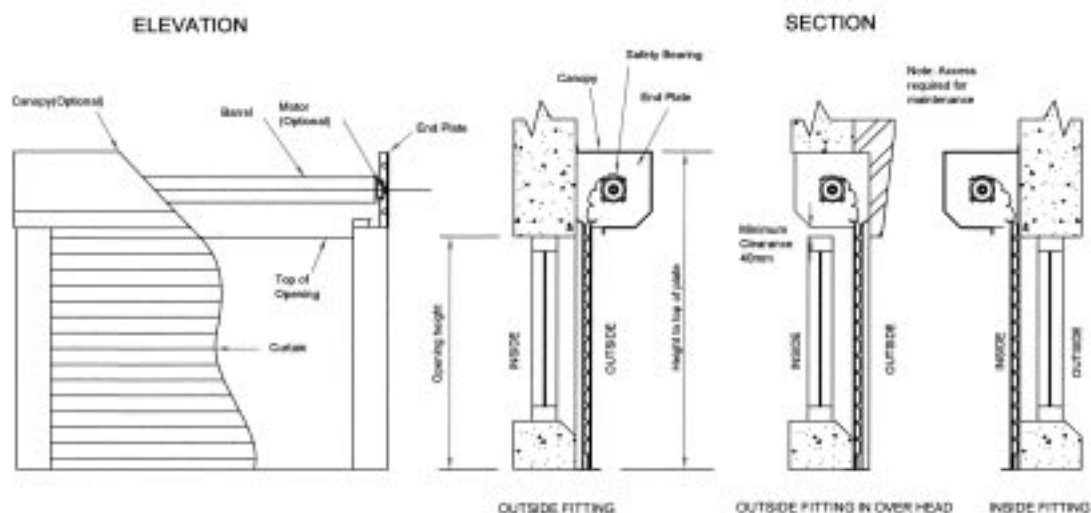

$$\text{Height to top of plate} = \text{Opening height} + \text{End Plate Dimension A} + 38 \text{ mm}$$

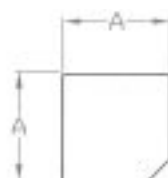

Manually Operated
End Plate Dimensions

Up to opening height (mm)	Dimension A (mm)
1200	280
2100	305
2700	330
3300	356
4000	380

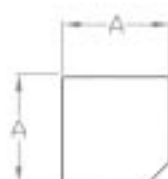

Electrically Operated
End Plate Dimensions

Up to opening height (mm)	Dimension A (mm)
2500	280
3000	305
3500	330
4500	343
5500	380

FITTING OPTIONS



PLAN

Face Fix



PLAN

Half Tunnel Fix



PLAN

Full Tunnel Side Fix

Fixing Details

Electrically Operated

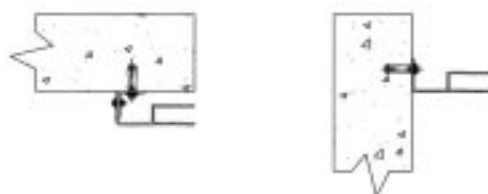

Manually Operated

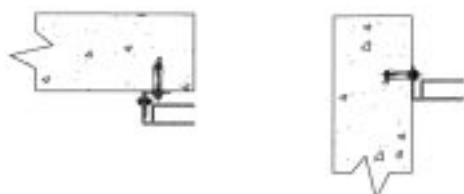

GUIDE PROFILES

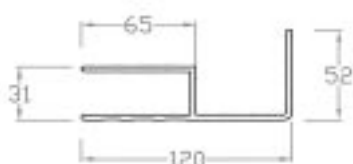

Electrically Operated
11 series

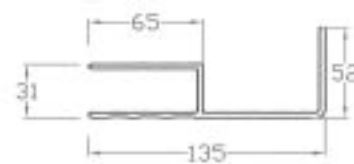

Electrically Operated
15 series

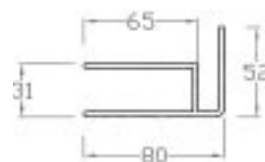

Manually Operated

Safety Features

At Hangar, safety is our priority. Remote Controlled Roller Shutters are fitted with a safety device to CE Standards. Should the door encounter an obstacle when closing, it will stop and reverse to clear the obstacle.

Automatic Roller Shutters operated by Rocker Switch or Key Switch employ Hold-To-Run operation - you must continuously operate the switch while closing, preventing the door from closing automatically without supervision. Inertia Safety Brakes are installed in accordance with CE standards.

Design Support

At Hangar, we support our products with a comprehensive Technical Advisory Service to Designers and Building Contractors. This service includes advice on Design Details, Fitting and General Application. Site Surveys are conducted in conjunction with Designers and Building Contractors to ensure Contracts are carried out in an efficient and professional manner.

Installation

We offer a Nationwide Installation Service, both technical and electrical, ensuring maximum efficiency.

After Sales Service

A complete service is available, with a full range of spare parts in stock. Planned Maintenance Contracts are highly recommended. Contact us for further details.

Optional Extras

Remote Control - Convenient and timesaving, a remote control allows you to operate your electrically operated Hangar Roller Shutter from the comfort of your vehicle, especially useful in adverse weather conditions. Group control affords you the convenience of pressing one button to operate multiple Roller Shutters.

Canopies - Canopies are designed to hide your curtain from view when opened. Canopies are powder coated to complement your curtain.

Fascia - We can design and manufacture a fascia to ensure an attractive finish to your premises. Fascia can be powder coated to suit your colour requirements.

Ground Locks - Fitted to the Base Section of the curtain, and built into the ground, Ground Locks are recommended for premises in high-risk areas providing extra security and peace of mind.

Sill Locks - Used on Window Shutters, Sill Locks are recommended for Hand Operated Roller Shutters and for added security on Automatic Shutters.

Note: Ground Locks & Sill Locks must be unlocked before operating your HRD65.



Industrial Roller Doors



Insulated Sectional Overhead Doors



Garage Doors



High Speed Doors



Steel Personnel Doors



Roller Shutters



Fire Shutters



Loading Bay Equipment